

# FM300



## Safety ensured by Pinch Force Measurement

The **FM300** from DriveTest is an electronic pinch force measuring system for power driven elevator doors. Typical applications include final inspection of new installations, and periodic conformance testing of existing equipment. Combining rugged construction with precision, the advanced mechanical design delivers exact measurements, even after years of service in an industrial environment. The FM300 has been tested and certified by the German TÜV Nord.

Sites with multiple elevator doors call for fast and easy performance of repetitive measurements. DriveTest has responded to this requirement by developing software which streamlines the measurement process and drastically reduces documentation effort. Measurements made on a complete site can be entered, printed as a table,

and stored in a database with a minimum of user entries. The investment in an FM300 system repays itself within a short time.

**DriveTest** is one of the pioneering companies in the field of pinch force measurement and offers a broad range of different systems for a variety of applications. Major customers include the Deutsche Bahn and major international airports.

- **Dependable** – certified by the TÜV Nord
- **Applicable standards** – EN 81-1, EN 81-2, EN-953
- **Precision measurements** – uses single point load cell
- **Robust construction** – casing manufactured from durable aluminium for long service life in industrial environments
- **Ease of Use** – single button operation
- **Supplied with all components** – high-quality transportation case and software included, no additional items to purchase
- **Professional, feature-rich software** – PinchPilot offers complete functionality
- **Determination of all relevant parameters** – peak force, residual pinch force, energy, and velocity
- **Complete customer support** – in-house calibration service, standards update service ensures use of newest standards version.
- **Software support** – integration in existing software infrastructure available



## → Technical specifications FM300

### Sensor FM300

Measurement Range	0 – 1,000 N
Measurement Tolerance	+/- 3 N or 3 %, whichever is greater
Stiffness	25 N/mm
Gap width	140 – 510 mm
Diameter	58 mm
Measurement Technique	Strain Gauge Bridge
Size	290 x 140 x 60 mm
Weight	1.7 kg

### Electronic Box SEB2

- Complete measurement unit in combination with sensor (PC optional when measuring)
- LCD Display
- Powered via one 9 V battery
- Onboard clock
- Storage for appr. 100 measurements
- Sensor and PC interfaces
- Displays peak force and pass/fail assessment

### PC Analysis Software PinchPilot

- Multi-Language (D, GB, I, F, E)
- Graphical display of Force vs. Time
- Calculation of relevant parameters
- Assessment with respect to different standards
- Support for user defined standards
- Printed reports
- Data export (Excel, Word)

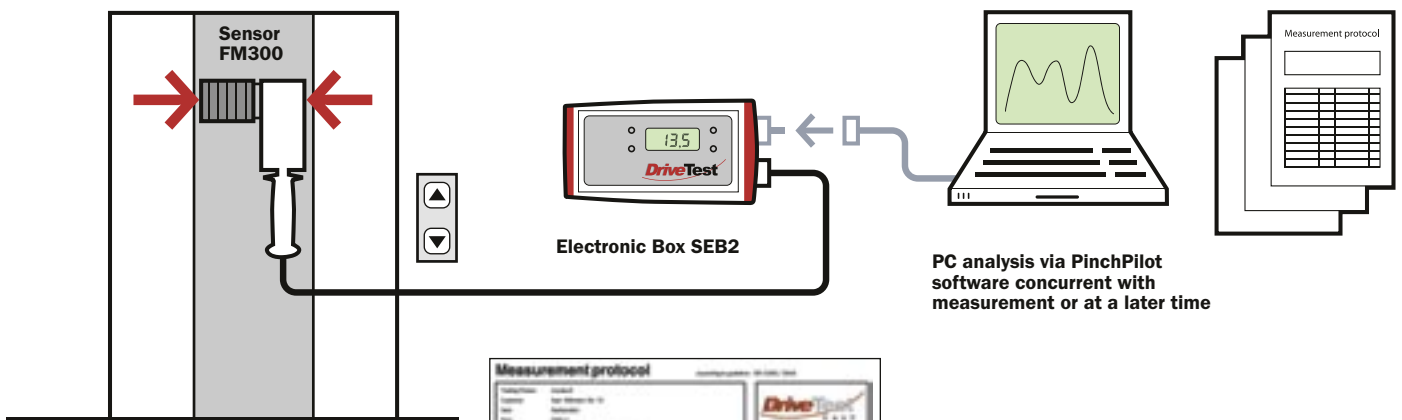

PC analysis via PinchPilot software concurrent with measurement or at a later time

### PC Analysis Software PinchPilot (included)

#### System Requirements

- Operating System Windows 98 SE, NT, 2000, XP
- CPU Pentium ≥ 133 MHz
- RAM ≥ 32 MB
- Free Disk Space ≥ 50 MB
- CD ROM Drive
- RS232 or USB Interface

### What's included

- Sensor with 3.5 m connection cable
- Separate data logging module (Electronic Box SEB2) with LCD display, LED display, membrane input key, and serial interface
- 9 V Battery
- Aluminium transportation case with foam inserts for ease of storage and transport
- PC connection cable (RS232, USB)
- CD with PinchPilot PC analysis software and documentation
- Users Manual in English and German
- Calibration certificate



[www.drivetest.de](http://www.drivetest.de)

**DriveTest**