

Pneumatic grip 3.5 kN

Universal pneumatic grip with 34 mm opening.
Paper, plastic, wooden samples.

TH108 grips are supplied in pairs, but can also be ordered as a single grip (0.5 pair). Grips and jaws need to be ordered separately.



Item No.	TH108
Clamping force	3.5 kN/7 bar (8 kN/16 bar)
Temperature range	0 to + 70°C Other temperature ranges on request
Body	Aluminum, anodized
Pneumatic connection	1/8"
Weight per grip	1.3 kg each grip (without jaws)
Scope of delivery	1 pair of grips (without jaws)

Jaws for TH108* Scope of delivery 1 set = 4 jaws

Item No.	Jaw surface	Clamping surface H x W	Opening	Weight / pair
TH108-B	Blank (smooth) jaws	50x50 mm	0-34 mm	0.38 kg
TH108-BG	Rubber jaws	50x50 mm	0-32 mm	0.38 kg
TH108-BV4	V-jaws	Clamping height 50 mm	4-30 mm Ø	0.45 kg
TH108-BP	Pyramid (serrated) jaws	50x50 mm	0-34 mm	0.36 kg
TH108-BW	Wave jaws	50x50 mm	0-34 mm	0.34 kg
TH108-BD	Diamond jaws	50x50 mm	0-34 mm	0.38 kg
TH108-B100	Blank (smooth) jaws	50x100 mm	0-34 mm	0.76 kg
TH108-BG100	Rubber jaws	50x100 mm	0-32 mm	0.78 kg
TH108-BP100	Pyramid (serrated) jaws	50x100 mm	0-34 mm	0.72 kg
TH108-BW100	Wave jaws	50x100 mm	0-34 mm	0.69 kg
TH108-BD100	Diamond jaws	50x100 mm	0-34 mm	0.76 kg

*Jaws with differing dimensions and surfaces available on request.

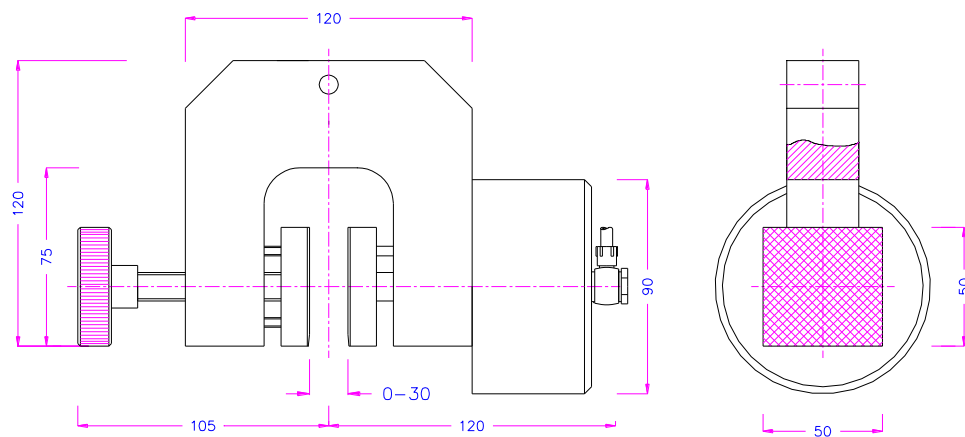

TH108

Jaw surfaces



TH108-B
Blank jaws
without counting



TH108-BG
Rubber coating
1 mm (NBR)

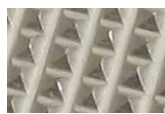

TH108-BP
Pyramids 1.2x45°,
hardened steel



TH108-BV
Tooth pitch 1.2 mm,
hardened steel



TH108-BW
Wave 5 mm,
hardened steel



TH108-BD
Diamond coating
(synthetic)



TH108+BW100



TH108-BW100



TH108-BG100



TH108-BP100

Other versions and customer-built solutions:



TH108-12 Opening up to 60 mm

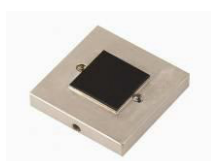

TH108-BG25x25



TH108-BP0.8x45 (small pyramids)

Accessories:**TH205-1 Foot pedals**

None locking: The jaws of the grip open by pressing the foot pedal and close after removing the foot from the pedal.

Scope of delivery: 1 pair of foot switches including tubes and fittings

**TH205-2 Foot pedals**

With locking function: The jaws of the grip open by pressing the foot pedal and remain opened after removing the foot from the pedal. The jaws close by pressing the pedal one more time.

Scope of delivery: 1 pair of foot switches including tubes and fittings

**TH205-+PR Pressure regulator**

Optional for TH205-1 or TH205-2

To adjust air pressure: 1-10 bar

**TH205-3 Hand switches**

With locking function: The jaws of the grip close by pulling the handle and remain closed. The jaws open by pushing the handle back.

Scope of delivery: 1 unit of hand switches including tubes and fittings

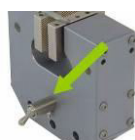
**TH205-4-1/8" Hand switches**

Pneumatic micro – hand switches, tubes and fittings, 1/8" connection

With locking function

The hand switches are directly mounted at the grips. 3/2 directional valve

Scope of supply: 2 hand switches including tubes and fittings

**TH216 Compressor for laboratories, oil-lubricated**

Max pressure 16 bar, 230 V, noise level: 38dB(A)/1m

Displacement 5 l/min, tank size 3.1 litre (0.82 gallon)

Dimensions: 340x290x340 mm (L x W x H); weight 16 kg

Different voltages available on request

Overview:

TH108.jpg



TH108..jpg



TH108-BW100.jpg



TH108-BW.jpg



TH108-BV.jpg



TH108-BP60x60.jpg



TH108-BP100.jpg



TH108-BP.jpg

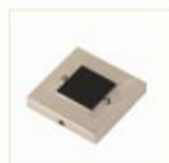

TH108-BG_rubber.jpg

TH108-BG25x25
grab.jpg

TH108-BG100.jpg

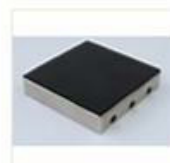

TH108-BG1.jpg



TH108-BD.jpg



TH108-B_blank.jpg



TH108-B100.jpg



TH108-12.jpg



TH108+BW100.jpg



TH108-BG_cr.jpg

See also:

www.grip.de/pdf/TH205_Datasheet.pdf

www.grip.de/pdf/TH216_Datasheet.pdf

www.grip.de/G12

18.01.2016OI